

PHILIPP GROUP

PHILIPP Lifting insert double sided

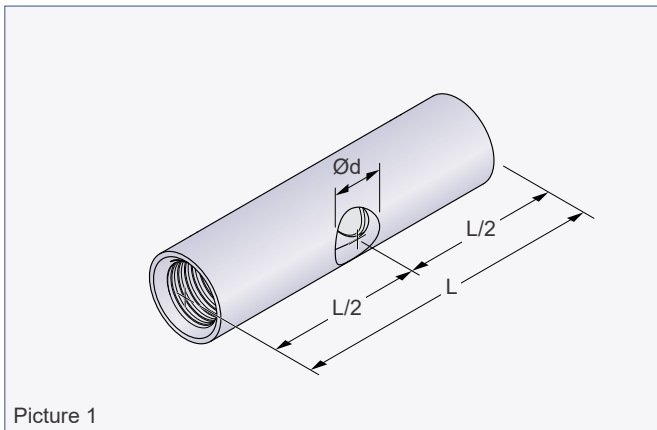

PHILIPP Lifting insert double sided



Picture 1

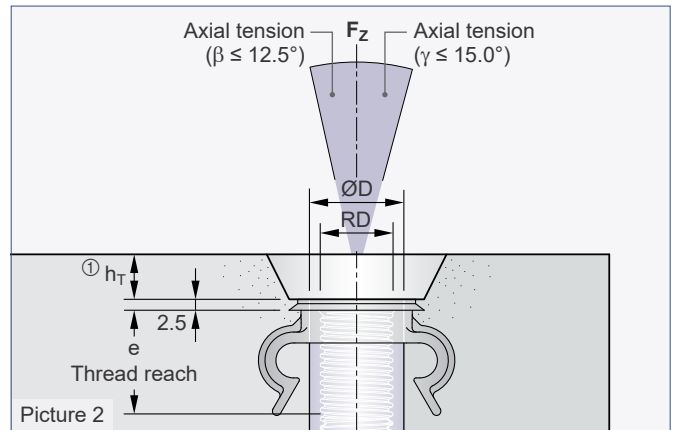

Picture 2

The Lifting insert double sided is a lifting insert with a cross hole and threads on both sides. The use of Lifting insert double sided requires the General Installation and Application Instruction, the Application Instructions for the belonging PHILIPP lifting devices as well as the data sheets of the PHILIPP accessories.

i The EC Declaration of Conformity (DoC) of the Lifting insert double sided is available on request or can be downloaded from our website www.philipp-group.de.



Table 1: Permissible load bearing capacities of steel and dimensions

Ref.-No. ② galvanised	Type	perm. F ③ [kN]	RD	Dimensions			Weight [kg/100 Stck.]
				L [mm]	e [mm]	Ød [mm]	
71HM12D	RD 12	5.0	12	60	22	8	3,5
71HM14D	RD 14	8.0	14	70	25	10	6,5
71HM16D	RD 16	12.0	16	80	27	13	10,0
71HM18D	RD 18	16.0	18	90	34	13	15,0
71HM20D	RD 20	20.0	20	95	35	16	19,0
71HM24D	RD 24	25.0	24	115	43	18	28,0
71HM30D	RD 30	40.0	30	145	56	23	59,0
71HM36D	RD 36	63.0	36	175	68	27	100,0
71HM42D	RD 42	80.0	42	205	75	32	159,0
71HM52D	RD 52	125.0	52	275	95	40	330,0

① Mind the embedding depth h_T of the according Recess former (Picture 2)

② Also available in stainless steel (Ref.-No. 77HM__DVA)

③ Load bearing capacity of steel for axial tension. The weight of 1.0 t corresponds to 10.0 kN

Material

The Lifting inserts double sided are made of special high precision steel tubes and are galvanised according to common standards. Two internal sealing caps close the threaded part of the insert in order to avoid the penetration of concrete. This galvanisation protects the anchor temporarily from the storage at the producer site to the final installation in the concrete element.

Corrosion

In order to avoid contamination or damage to the concrete surface of the precast concrete element due to corrosion of the transport anchor (stream of rust or similar), the Lifting inserts double sided can be delivered in stainless steel alternatively.



If you have further questions, please have a look at our website www.philipp-group.de or call our technical department under +49 6021 4027-318 resp. send an email to technik@philipp-group.de.